

Cable tray L51

EI no. 3837+ **EAN no.** 5703796+ **Dim.**
Manufactured from galvanized steel plate
Standard length 3 m.

115.055	115.051	50mm
115.071	115.075	70mm
115.107	115.105	100mm
115.136	115.136	150mm
115.149	115.143	200mm
115.165	115.167	300mm
115.181	115.181	400mm
115.204	115.204	500mm

CABLETRAY L51
 Mainly used for light purpose in industries, hospitals, schools, office office, buildings etc.
 50mm are delivered with center holes 15x30mm
 70mm - 300mm are delivered with centerholes 20x45mm

Fish plate XLA50 to be used with 100-500mm cabletray.
 For 50-70mm use the fish plate LA50.

50 - 70mm

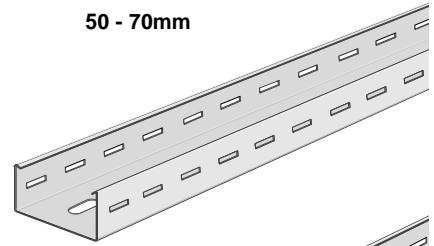

100 - 300mm

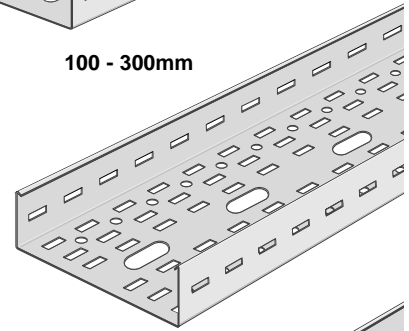

400 - 500mm

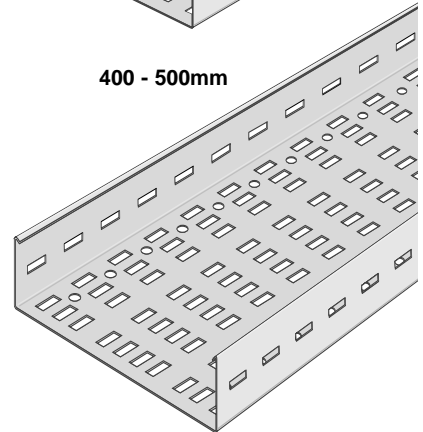

151.051	151.059	50mm
151.077	151.073	70mm
151.103	151.103	100mm
151.132	151.134	150mm
151.145	151.141	200mm
151.161	151.165	300mm
151.187	151.189	400mm
151.200	151.202	500mm

FLAT BEND 90° TYPE 50H...
 Available for all dimensions shown. If unequal ports are required state port dimension in the order given by the index (1 - 2)

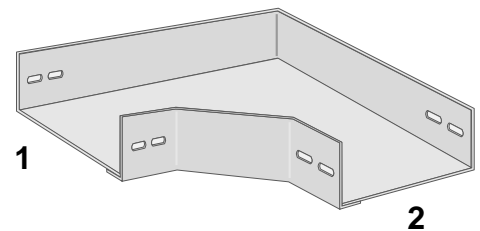

151.909	151.905	
---------	---------	--

UNIVERSAL CORNER PIECE

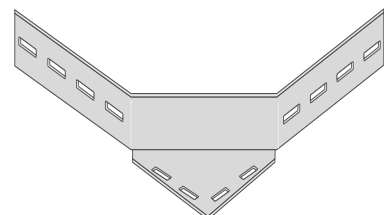



Cable tray L51

El no. 3837+ EAN no. 5703796+ Dim.

Manufactured from galvanized steel plate

161.054	116.058	50mm
161.070	161.072	70mm
161.106	161.102	100mm
161.135	161.133	150mm
161.148	161.140	200mm
161.164	161.164	300mm
161.180	161.188	400mm
161.203	161.201	500mm

T-JUNCTION TYPE 50T...
Available for all dimensions shown.
If unequal ports are required state port dimension in the order given by the index (1 - 2 - 3)

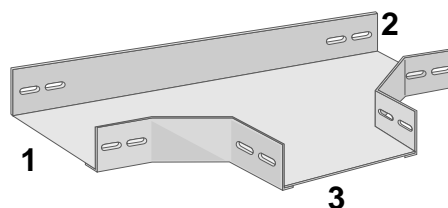

171.057	171.057	50mm
171.073	171.071	70mm
171.109	171.101	100mm
171.138	171.132	150mm
171.141	171.149	200mm
171.167	171.163	300mm
171.183	171.187	400mm
171.206	171.200	500mm

CROSS TYPE 50X..
Available for all dimensions shown.
If unequal ports are required state port dimension in the order given by the index (1 - 2 - 3 - 4)

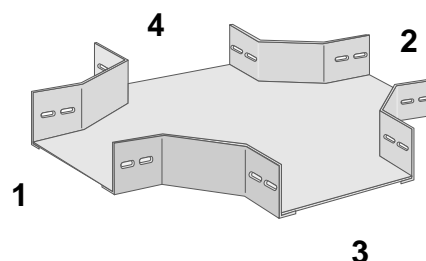

NB!
Parts for joining different tray widths made to order

Elno. 3837+ EAN no. 5703796+ Dim.

External and internal riser is only available in a limited number

174.054	174.058	50mm
174.070	174.072	70mm
174.106	174.102	100mm
174.135	174.133	150mm
174.148	174.140	200mm
174.164	174.164	300mm
174.180	174.188	400mm
174.203	174.201	500mm

EXTERNAL RISER TYPE 50F..
Available for all dimensions shown.

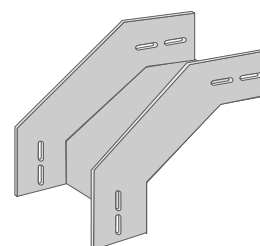

175.053	175.055	50mm
175.079	175.079	70mm
175.105	175.109	100mm
175.134	175.130	150mm
175.147	175.147	200mm
175.163	175.161	300mm
175.189	175.185	400mm
175.202	175.208	500mm

INTERNAL RISER TYPE 50S..
Available for all dimensions shown.

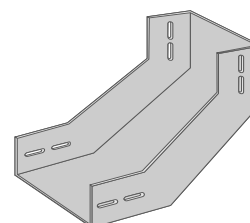

Parts for joining different tray widths made to order

State port dimension in the order given by the index (1 - 2)

STRAIGHT REDUCER 50R(1 - 2)

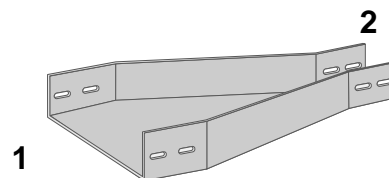

RIGHT HAND REDUCER 50RR(1 - 2)

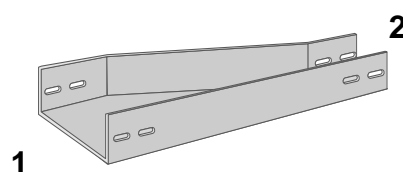

LEFT HAND REDUCER 50RL(1 - 2)

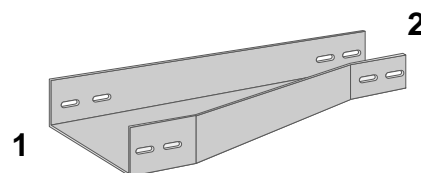

125.058	125.050	50mm
125.074	125.074	70mm
125.100	125.104	100mm
125.139	125.135	150mm
125.142	125.142	200mm
125.168	125.166	300mm
125.184	125.180	400mm
125.207	125.203	500mm

COVERPLATE DL

15mm edges
Standard length 3 m.

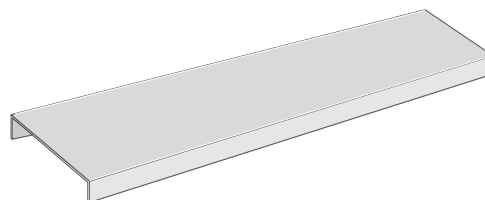

125.906 125.906

LOCKCLAMP

For coverplate DL
To be used with carriage bolt M6x10
Se page 6.4



Cable tray L51- accessories

BOLTS and NUTS
DELTA is a patented surface treatment.
fzb is electro-galvanize.

El no. **EAN no.**
3839+ **5703796+**

El no.	EAN no.	Dim.	Description	Material
110.016	110.018	M6x10	CARRIAGE BOLT Set w/nut	fzb
110.061	110.063	6 mm	MUT	fzb
110.074	110.070	6 mm	WASHER	fzb
110.087	110.087	6 mm	LOCK-WASHER	fzb
110.090	110.094	M6x10	CARRIAGE BOLT LB 10	fzb
110.100	110.100	M6x16	CARRIAGE BOLT Set w/nut and washer	DELTA
110.155	110.155	M10 x20	MOUNTINGBOLT	DELTA
110.168	110.162	10 mm	NUT	fzb
110.171	110.179	10 mm	WASHER	fzb
110.184	110.186	M8 x10	MOUNTINGBOLT	fzb
110.278	110.278	10 mm	LUCK-WASHER	fzb
110.702	110.704	6 mm	NUT	DELTA
110.715	110.711	6 mm	WASHER	DELTA
110.728	110.728	6 mm	LUCK-WASHER A2	STAINLESS STEEL
111.099	111.091	M6 x16	CARRIAGE BOLT LB 16	DELTA
112.098	112.098	M6x20	CARRIAGE BOLT LB 20	DELTA
112.166	112.166	10 mm	NUT	DELTA
112.179	112.173	10 mm	WASHER	DELTA

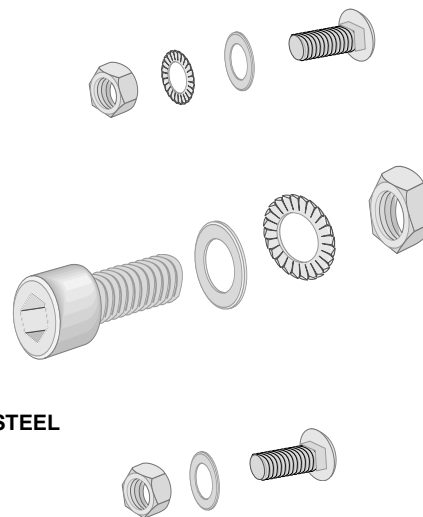

3839+ 5703796+

110.500 110.506
FISH PLATE XLA50
 Only usefull at cabletrays 100-500mm
 For 50 and 70mm use LA50

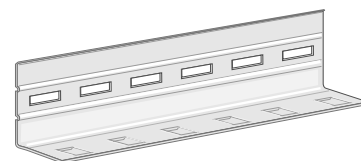

110.555 110.551
FISH PLATE LA50
 To be used with 4 carriage bolts LB M6x10

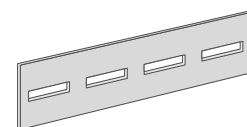

110.597 110.599
FISH PLATE LONG LA50L

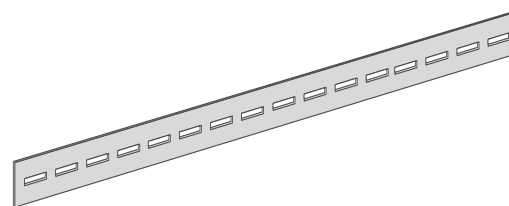

110.652 110.650
UNIVERSAL HINGE PLATE KLA50
 Mounting hole ø11
 To be used with 2 carriage blots LB M6x10

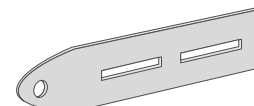

Cable tray L51- accessories

El no. 3837+ EAN no. 5703796+ Dim. Manufactured from galvanized steel plate

110.908 110.902

CLAMP DSL.
DSL is special designed for mounting af barrier strip type DS, but it is a multipurpose clamp suitable for any accessory To be mounted without tools

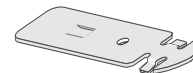

110.953 110.957

BARRIER STRIP DS
Standard length 3m

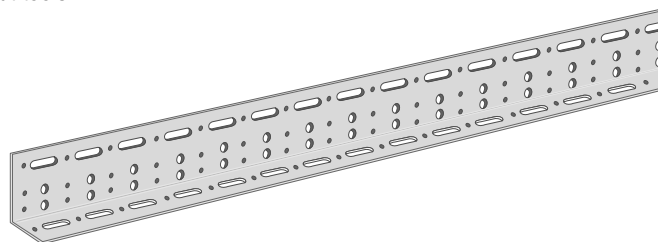

110.995 110.995

LOCK-CLIP
for cable trays

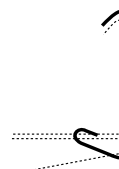

119.103 119.103 100 mm
119.132 119.134 150 mm
119.145 119.141 200 mm
119.161 119.165 300 mm
119.187 119.189 400 mm
119.200 119.202 500 mm

FISH PLATE
Bottom type

120.901 120.901

MOUNTING PLATE M
For mounting on cabletrays as support for junction boxes, power ports etc.
120x120mm

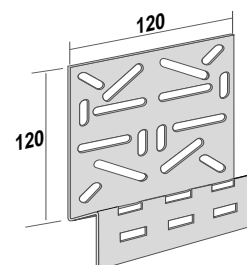

120.927 120.925

MOUNTING PLATE DM
As above
240x120mm.

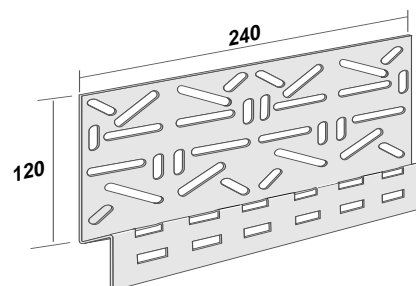

110.089 110.407

SOFT PROTECTIVE RING
PVC for 50 mm. cabletray



110.092 110.414

SOFT PROTECTIVE RING
PVC for 70-300 mm. cabletray
For the centerholes in the cabletrays



Technical data:

Moment of inertia:	$I_x = 4,3 \text{ cm}^4$
Section modulus:	$S = 2,0 \text{ cm}^3$
Surface treatment:	Galvanized steel plate
Steel quality:	DX 51D (275 g/m ²)
Standard length:	3 m

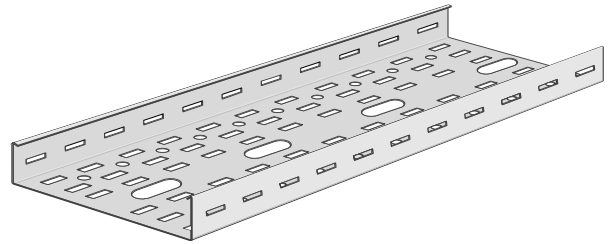

Calculation example:

Cable load:	$P_k = 80 \text{ Kg/m.}$
Deflection:	$U = 0,15 \text{ cm}$
Support distance:	$L = 150 \text{ cm}$
Safety factor against failure:	$S = 1,8$

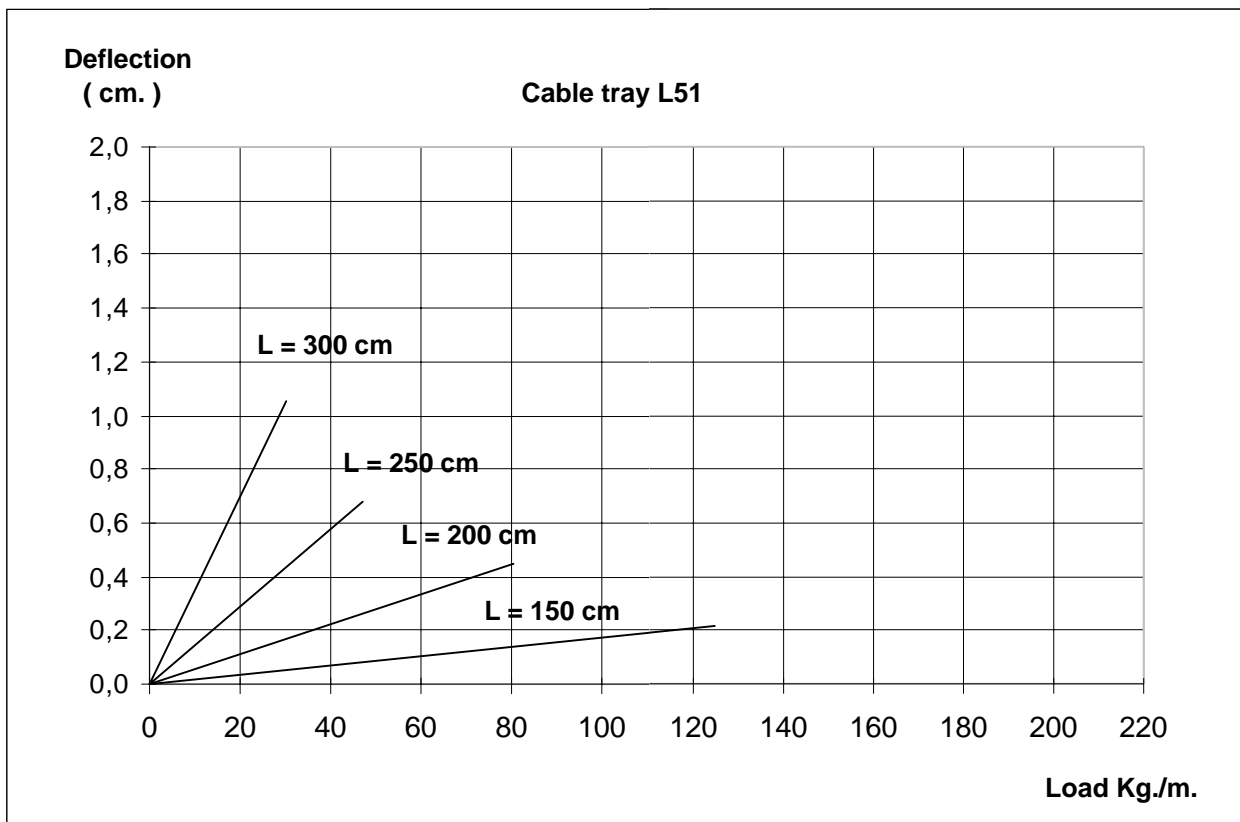

Deflection is calculated on the middelpoint of a continuous cable tray, with supports for every L meters

Eln. 3837+ EAN no. 5703796+ Dim. The system is hot dip galvanized according to DS/ISO 1461

Standard length 3 m.

135.051	135.059	50mm
135.077	135.073	70mm
135.103	135.103	100mm
135.132	135.134	150mm
135.145	135.141	200mm
135.161	135.165	300mm
135.187	135.189	400mm
135.200	135.202	500mm

CABLETRAY G51

A heavy duty cable tray with turned edges giving abundant stability with the lowest possible weight
Pre punched holes allows quick assembly and avoids drilling at site

50mm is delivered with center holes 15x30mm
70-300mm with 20x45mm center holes

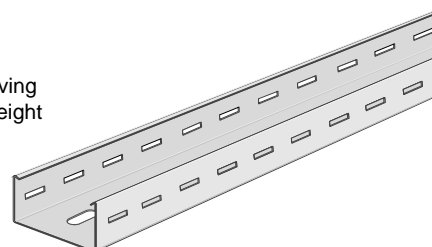

To be used with fishplate LA50G / KLA50G

152.050	152.056	50mm
152.076	152.070	70mm
152.102	152.100	100mm
152.131	152.131	150mm
152.144	152.148	200mm
152.160	152.162	300mm
152.186	152.186	400mm
152.209	152.209	500mm

FLAT BEND 90° TYPE 50H..G

Available in all dimensions shown
If unequal ports are required state port dimension in the order given by the index (1 - 2)

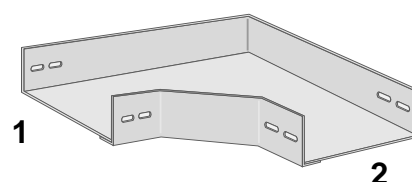

152.908	152.902	
---------	---------	--

UNIVERSAL CORNER PIECE HJG

For branching

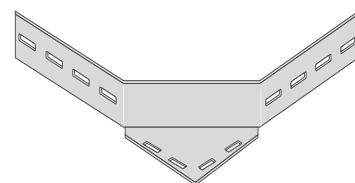

162.053	162.055	50mm
162.079	162.079	70mm
162.105	162.109	100mm
162.134	162.130	150mm
162.147	162.147	200mm
162.163	162.161	300mm
162.189	162.185	400mm
162.202	162.208	500mm

T- JUNCTION TYPE 50T..G

Available in all dimensions shown
If unequal ports are required state port dimension in the order given by the index (1 - 2 - 3)

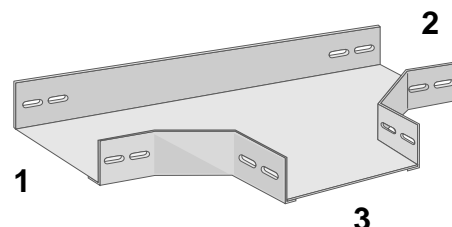

172.056	172.054	50mm
172.072	172.078	70mm
172.108	172.108	100mm
172.137	172.139	150mm
172.140	172.146	200mm
172.166	172.160	300mm
172.182	172.184	400mm
172.205	172.207	500mm

CROSS TYPE 50X..G

Available in all dimensions shown
If unequal ports are required state port dimension in the order given by the index (1 - 2 - 3 - 4)

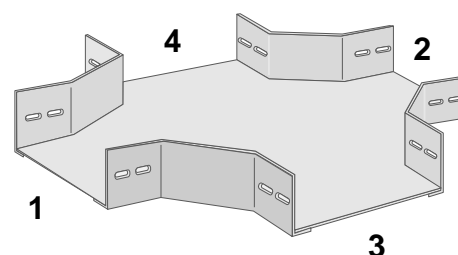

NB!

Parts for joining different tray widths made to order

136.050	136.056	50mm
136.102	136.100	100mm
136.131	136.131	150mm
136.144	136.148	200mm
136.160	136.162	300mm
136.186	136.186	400mm
136.209	136.209	500mm

COVERPLATE DHG

35mm edges
Standard length 3 m

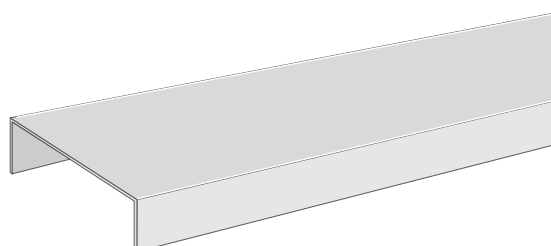



Cable tray G51 - accessories

DELTA is a patented surface treatment

El no.	EAN no.	Dim.		
3839+	5703796+			
110.100	110.100	M6x16	CARRIAGE BOLT Set w/ washer and nut	DELTA
110.155	110.155	M10 x20	MOUNTINGBOLT	DELTA
110.702	110.704	6 mm	NUT	DELTA
110.715	110.711	6 mm	WASHER	DELTA
110.728	110.728	6 mm	LUCK-WASHER A2	STAINLESS STEEL
111.099	111.091	M6 x16	CARRIAGE BOLT LB 16	DELTA
112.098	112.098	M6x20	CARRIAGE BOLT LB 20	DELTA
112.166	112.166	10 mm	NUT	DELTA
112.179	112.173	10 mm	WASHER	DELTA

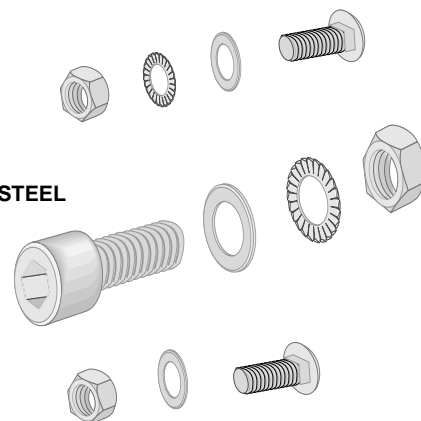

El no. 3837+
EAN no. 5703796+

130.959 130.955 **BARRIER STRIP DSG**

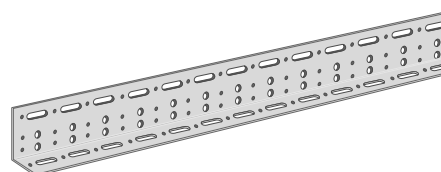

130.551 130.559 **FISH PLATE LA50G**
To be used with 4 carriage bolst LB m6x16

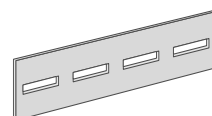

130.593 130.597 **FISH PLATE LONG LA50LG**
To be used with carriage bolts LB m6x16

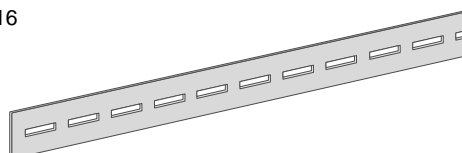

130.658 130.658 **UNIVERSAL HINGE PLATE KLA50G**
Mounting hole ø11
To be used with 2 carriage bolts LB m6x16

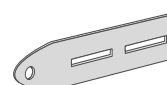

130.904 130.900 **MOUNTING PLATE MG**
For mounting on cable trays as support for junction boxes, power ports etc.
120 x120mm

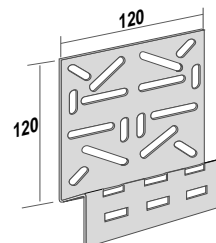

130.920 130.924 **MOUNTING PLATE DMG**
As above
240 x120mm

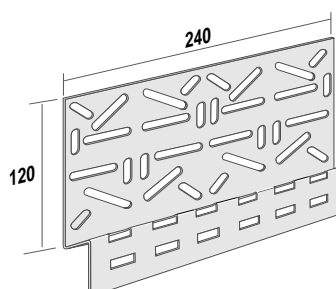

Technical data:

Moment of inertia	$I_x = 8,2 \text{ cm}^4$
Section modulus:	$S = 4,2 \text{ cm}^3$
Surface treatment:	Hot dip galvanized according to DS/ISO 1461.
Steel quality:	DC 01 AM
Standard length:	3 m

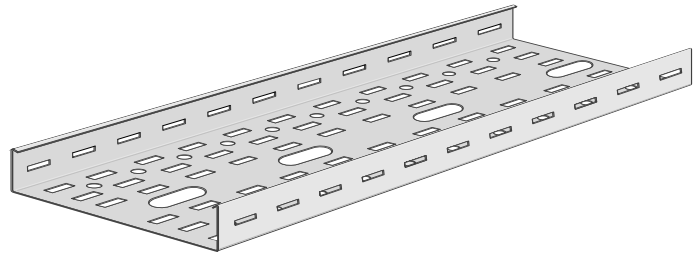

Calculation example:

Cable load:	$P_k = 80 \text{ Kg/m}$
Deflection:	$U = 0,6 \text{ cm}$
Support distance:	$L = 250 \text{ cm}$
Safety factor against failure:	$S = 1,6$

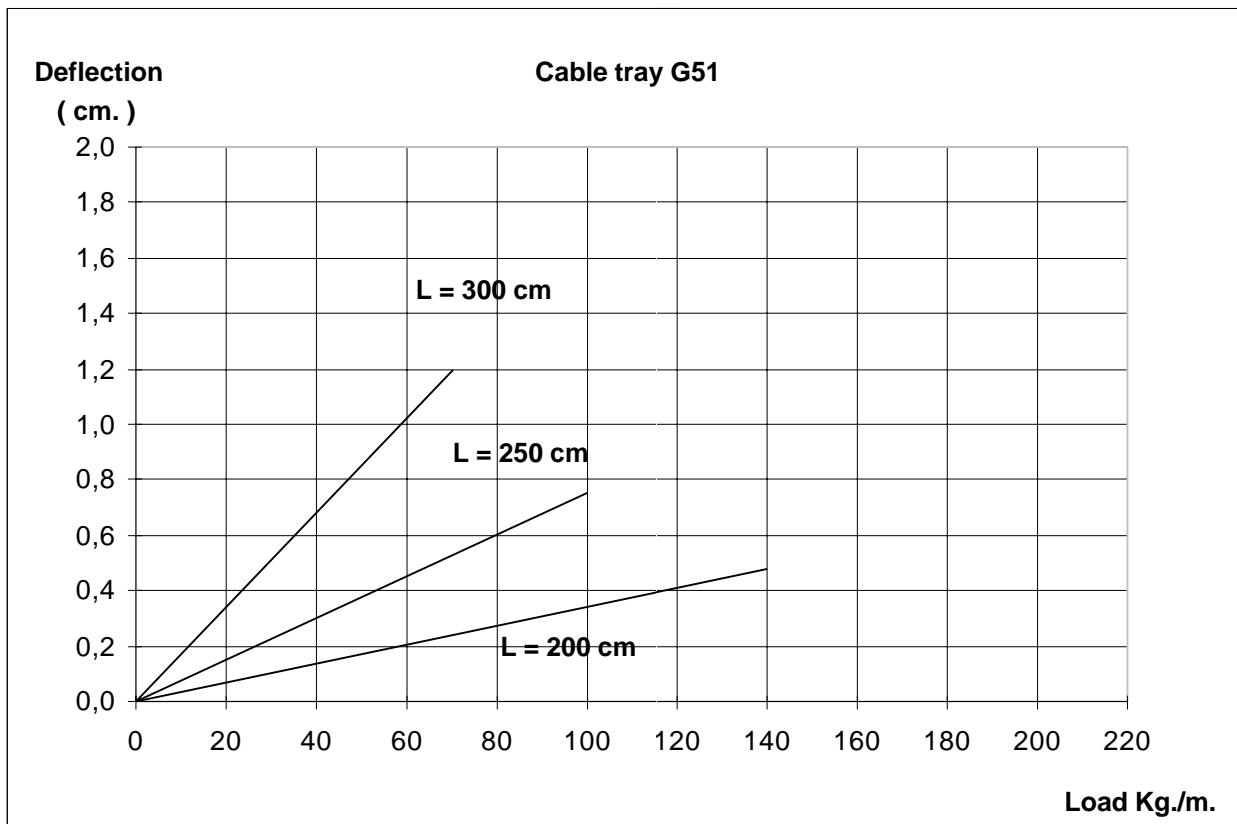

Deflection is calculated on the middelpoint of a continuous cable tray, with supports for every L meters.

El no. EAN no.+
 3837+ 5703796+ Dim.

Cable tray of stainless steel SIS2343 (ASTM 316)
 Normally only a limited number in stock

Standard length 3 m.

142.057	142.057	50mm
142.109	142.101	100mm
142.138	142.132	150mm
142.141	142.149	200mm
142.167	142.163	300mm

STAINLESS STEEL CABLETRAY SS52
 A heavy duty cable tray with turned edges

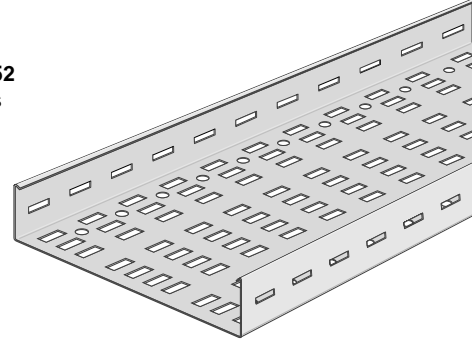

182.059	182.053	50mm
182.101	182.107	100mm
182.130	182.138	150mm
182.143	182.145	200mm
182.169	182.169	300mm

45 ° FLAT BEND SS52
 Available in all dimensions shown
 If unequal ports are required state port dimension in the order given by the index (1 - 2)

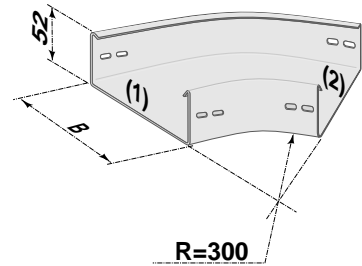

184.057	184.057	50mm
184.109	184.101	100mm
184.138	184.132	150mm
184.141	184.149	200mm
184.167	184.163	300mm

90 ° FLAT BEND SS52
 Available in all dimensions shown
 If unequal ports are required state port dimension in the order given by the index (1 - 2)

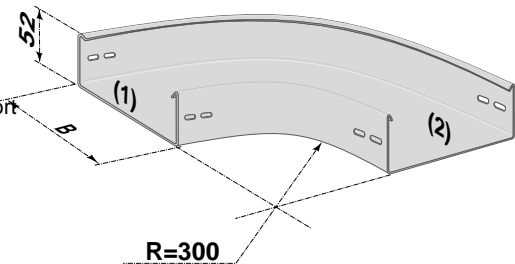

186.055	186.051	50mm
186.107	186.105	100mm
186.136	186.136	150mm
186.149	186.143	200mm
186.165	186.167	300mm

T-JUNCTION SS52
 Available in all dimensions shown
 If unequal ports are required state port dimension in the order given by the index (1 - 2 - 3)

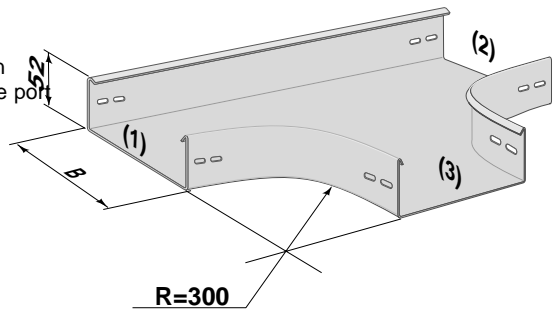



Elno. 3837+ EAN no. 5703796+ Dim.

Cable tray SS52

187.054	187.058	50mm
187.106	187.102	100mm
187.135	187.133	150mm
187.148	187.140	200mm
187.164	187.164	300mm

CROSS SS52
Available in all dimensions shown
If unequal ports are required state port dimension in the order given by the index (1 - 2 - 3 - 4)

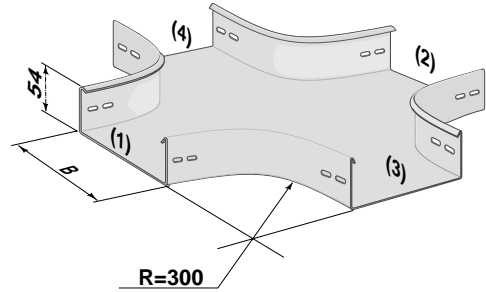

180.051	108.059	50mm
180.103	180.103	100mm
180.132	180.134	150mm
180.145	180.141	200mm
180.161	180.165	300mm

45° EXTERNAL RISER SS52
Available for all dimensions shown

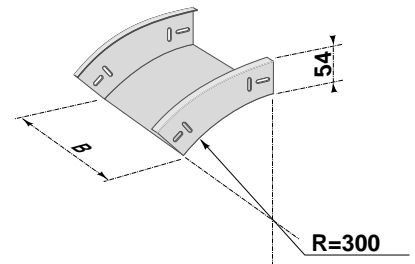

188.053	188.055	50mm
188.105	188.109	100mm
188.134	188.130	150mm
188.147	188.147	200mm
188.163	118.161	300mm

90° EXTERNAL RISER SS52
Available for all dimensions shown

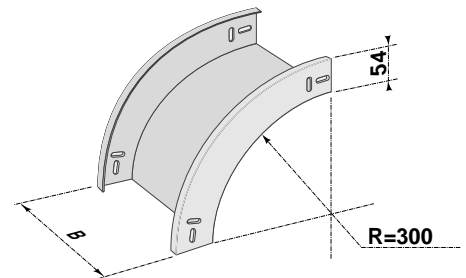

181.050	181.056	50mm
181.102	181.100	100mm
181.131	181.131	150mm
181.144	181.148	200mm
181.160	181.162	300mm

45° INTERNAL RISER SS52
Available for all dimensions shown

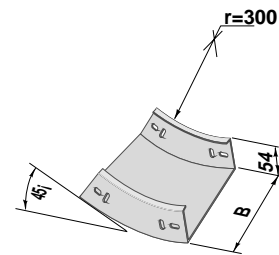

189.052	189.052	50mm
189.104	189.106	100mm
189.133	189.137	150mm
189.146	189.144	200mm
189.162	189.168	300mm

90° INTERNAL RISER SS52
Available for all dimensions shown

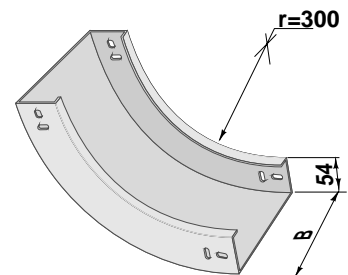

Parts for joining different tray widths
made to order

State port dimension in the order
given by the index (1 - 2)

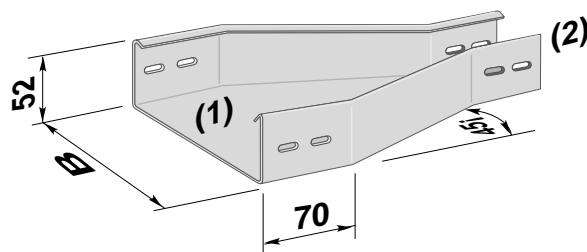

STRAIGHT REDUCER 52R
52R(1 - 2)SS

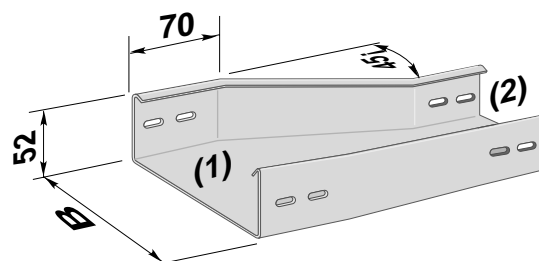

RIGHT HAND REDUCER 52RR
52RR(1 - 2)SS

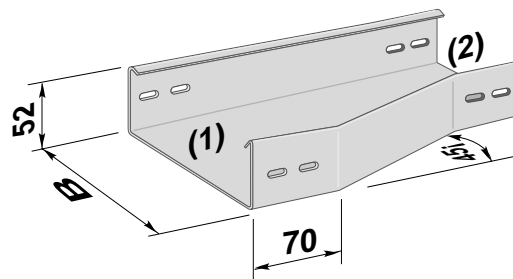

LEFT HAND REDUCER 52RL
52RL(1 - 2)SS

Cable tray SS52 - accessories

El no. 3839+ EAN no. 5703796+ Dim.

140.099	140.091	M6x16	STAINLESS CARRIAGE BOLT
140.073	140.077	6mm	STAINELSS WASHER
140.086	140.084	6mm	STAINLESS LOCK-WASHER
140.060	140.060	6mm	STAINLESS NUT
140.167	140.169	10mm	STAINLESS NUT
140.170	140.176	10mm	STAINLESS WASHER
140.183	140.183	10mm	STAINLESS LOCK-WASHER
140.196	140.190	M10x20	STAINLESS MOUNTINGBOLT

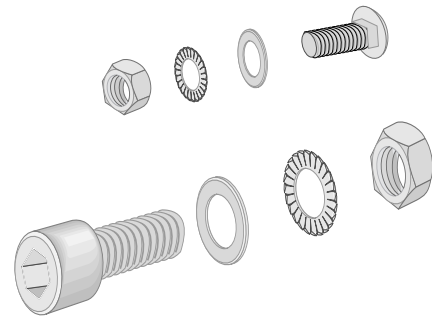

El no. 3837+ EAN no. 5703796+

140.952 140.954 **STAINLESS BARRIER STRIP DS-SS**
To be used with carriage bolts

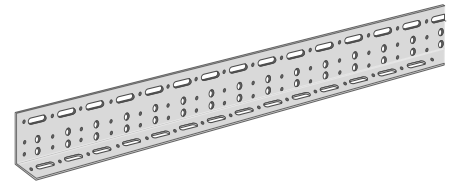

140.554 140.558 **STAINLESS FISH PLATE LA50SS**
To be used with 4 carriage bolts

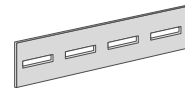

140.596 140.596 **STAINLESS FISH PLATE LONG LA50LSS**
To be used with carriage bolts

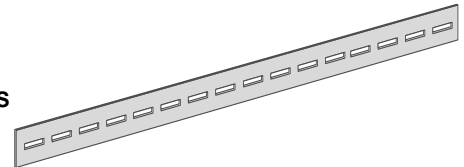

140.651 140.657 **STAINLESS UNIVERSAL HINGE PLATE KLA50SS**
Mounting hole ø11
to be used with 2 carriage bolts

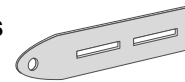

140.907 140.909 **STAINLESS MOUNTING PLATE M-SS**
For mounting on cable tray as supports for junction boxes, power port etc.
120 x 120mm

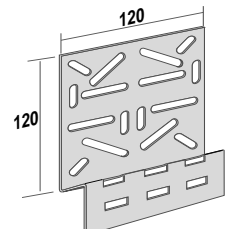

142.921 142.927 **STAINLESS MOUNTING PLATE DM-SS**
As above
240 x 120mm

